

CIRCLE TRAIN



Be Sure
to Read this
Manual
Before Use



Operation Manual

For Parts and Service, call Amusements Worldwide

www.amusementsworldwide.com

Tel: 972-241-4266

SERIAL NUMBER

DATE OF INSTALLATION

CONTENT

Important Safety Instructions	2
1. SPECIFICATIONS	4
2. PACKAGE CONTENTS.....	5
3. PART NAMES	6
4. SET UP & INSTALLATION.....	7
5. HOW TO PLAY	11
6. GAME OPTIONS	11
7. MAINTENANCE & INSPECTION.....	18
8. OVERALL CONSTRUCTION	19



WARNING

Non-technical personnel who do not have technical knowledge and Expertise should refrain from performing such work that this manual require or perform tasks which are not explained in this manual. Failing to comply can cause severe accidents such as electric shock or other serious injuries. All repairs must be performed to original manufacturer specifications.

WARNING: To reduce the risk of fire, electric shock or personal injury, unplug or disconnect the machine from the power supply before servicing.

Thank you for purchasing **Circle Train**. We hope you enjoy the product.

This manual contains valuable information about how to operate and maintain your game machine properly and safely. It is intended for the owner and/or personnel in charge of product operation. Carefully read and understand the instructions.

If you need any help during installation and setup please utilize this manual and troubleshooting guide. If the product fails to function properly, *non-technical personnel should under no circumstance attempt to service the machine*. Contact your distributor or manufacturer for help.

Before use, please read **IMPORTANT SAFETY INSTRUCTIONS**.

IMPORTANT SAFETY INSTRUCTIONS

To ensure the safe usage of this product, carefully read and understand these instructions before operating your game.

Save these instructions for future reference.

Use this product only as described in this manual. Other uses not recommended may cause fire, electric shock or personal injury. Unplug the game from the outlet when not in use, when moving from one location to another, and before cleaning/servicing.

Explanations which require special attention are indicated by signs of warning. Depending on the potential hazardous degree, the terms: **NOTE**, **NOTICE**, and **WARNING** are used.

NOTE: A NOTE indicates useful hints or information about product usage.

NOTICE: A NOTICE indicates potential damage to product and how to avoid the problem.

WARNING: A WARNING indicates a potential for product damage or serious personal injury.

It is important to understand the meaning of the following HAZARD SIGNS before continuing:

High Voltage and Shock Hazard:

High voltage can cause electric shock.
Turn off/unplug power before servicing.



High Temperature Hazard:

This part may cause scalding.
Do not touch. Surface may be hot.



No Touching Hazard:

This part may be hot or can cause electric shock.
Do not touch.



Use the following safety guidelines to help ensure your own personal safety and to help protect your equipment and surrounding environment from potential damage.

 **This product is an indoor game machine. Do not install outdoors.**

Avoid installing in the following places to prevent fire, electric shock, injury and/or machine malfunctioning:

- Places subject to rain/moisture, or places subject to high humidity.
- Places subject to direct sunlight, or places subject to extremely hot or cold temperatures to ensure that it is used within the specified operating range.
- Places where inflammable gas may be present or in the vicinity of highly inflammable/volatile chemicals or items that can easily catch fire
- On unstable or sloped surfaces. The machine may topple or cause unforeseen accidents.
- Vicinity of fire exits, fire extinguishers etc that may block/prevent safety measures

IMPORTANT NOTE:

ALL REPAIRS MUST BE DONE TO ORIGINAL MANUFACTURER SPECIFICATIONS. FAILURE TO DO SO VOID ALL WARRANTIES AND OPERATOR ASSUMES ALL RISKS.

Note: The contents of this manual may be updated without notice

1. SPECIFICATIONS

Rated power supply: 110V, 50/60Hz; 220V, 50Hz/60Hz

Min. Power consumption: 35W

Max. Power consumption: 120W

Dimensions: D2160xW1460xH1445(mm)

Weight: Approximately 155kgs

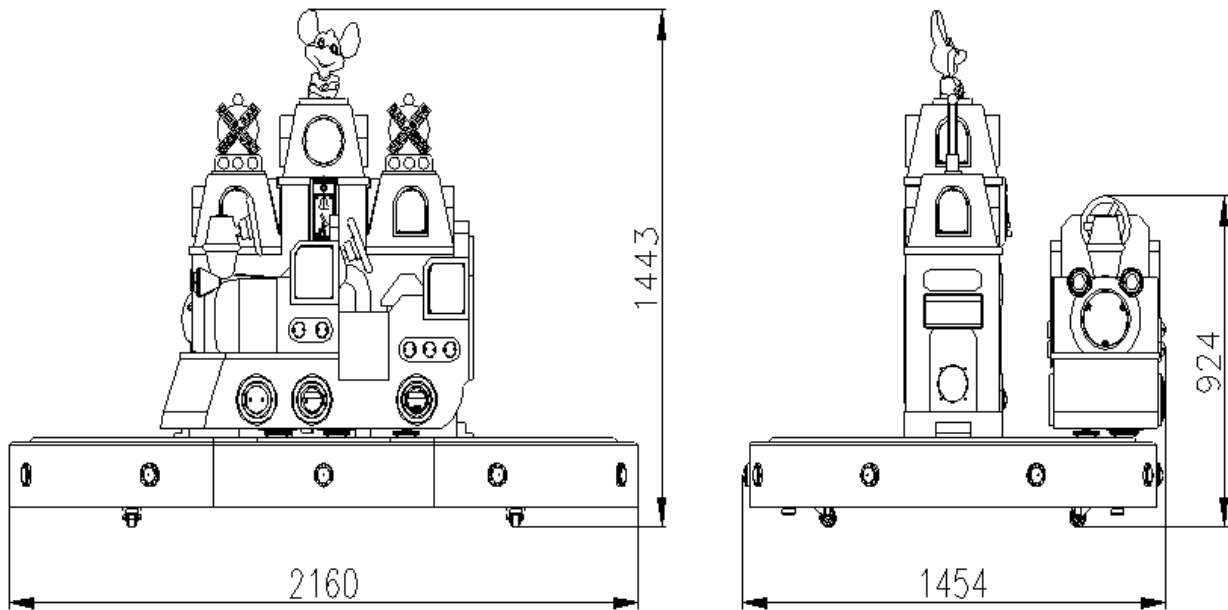



Note: Game parameters are subject to change without notice.

! **NOTICE:** After turning off the game, please wait at least 1 minute before restarting again.

2. PACKAGE CONTENTS

Open the package and make sure all the items are included:

- 1 x Body Assembly
- Following accessories

No.	Part No.	Code.	Name	Spec.	Qty.	Illustration
1	C135-451-000	23301010041	Power Cord	3X16AWG 1.8M	1	
2	C135-411-000	21901000004	Fuse	Φ5×20mm T5A 125VAC	1	
3	C135-450-000	41440000013	Manual	170512	1	
4	C135-449-000	25300000104	Key	C582	3	

If any items are found to be missing, please contact your sales representative for help immediately.

Warranty: Universal Space provides 90 days warranty for all electrical and mechanical components, when used under normal operating conditions. Any modification or abuse of these items immediately voids the warranty. Graphic and consumable items are exempt from any warranty.

NOTE: Part models are subject to change without notice.

3. PART NAMES

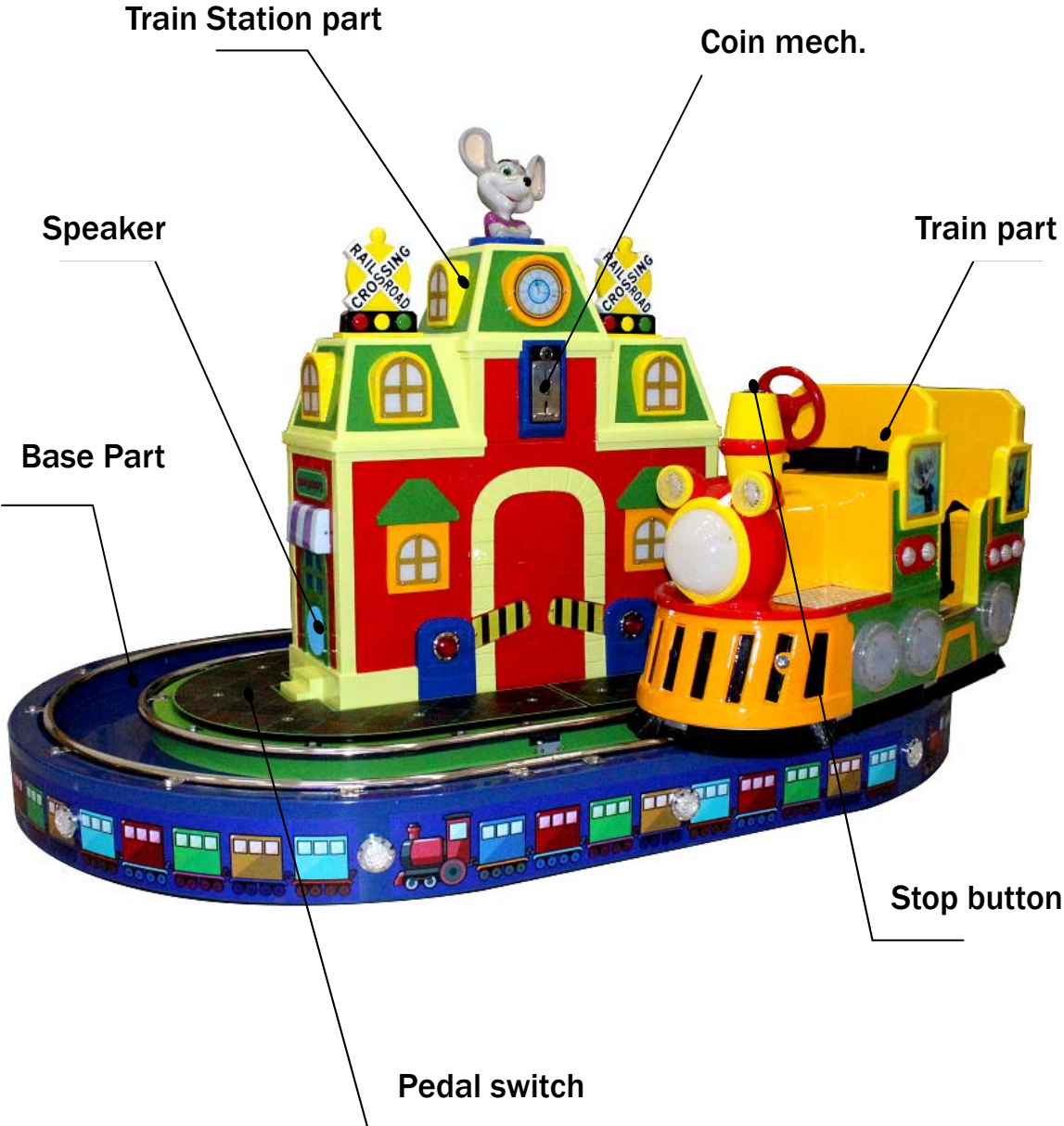

4. SET UP & INSTALLATION

 **This product is an indoor game machine. Do not install outdoors.**

- Refer to IMPORTANT SAFETY INSTRUCTIONS (Pg. 2) for places to avoid
- Place the unit on a dry level surface
- Ventilation openings in the back of the unit must not be obstructed by objects or by wall.

4.1 Initial Installation

Step 1 Put the train station upper fiberglass onto the train station bottom fiberglass. Insure the direction is correct for both parts.



Step 2 The upper part is hold by one service man and the other man connect the cable inside.

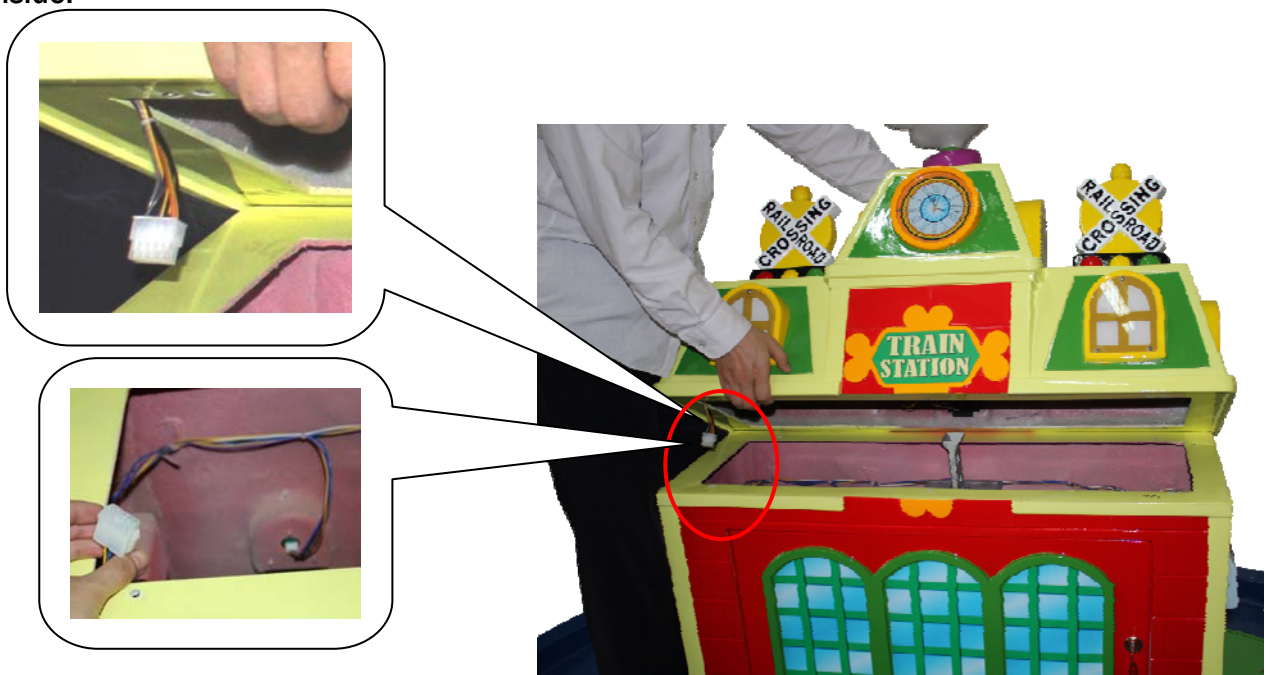

Step 3 Insure the upper part is aligned with the bottom part. Take 4 screws from the accessory box and fasten with nuts inside the fiberglass.



4.2 Play Zone

This machine requires space for playing and for maintenance as shown below. Leave space around the game upon installation:

Play area: 500 cm

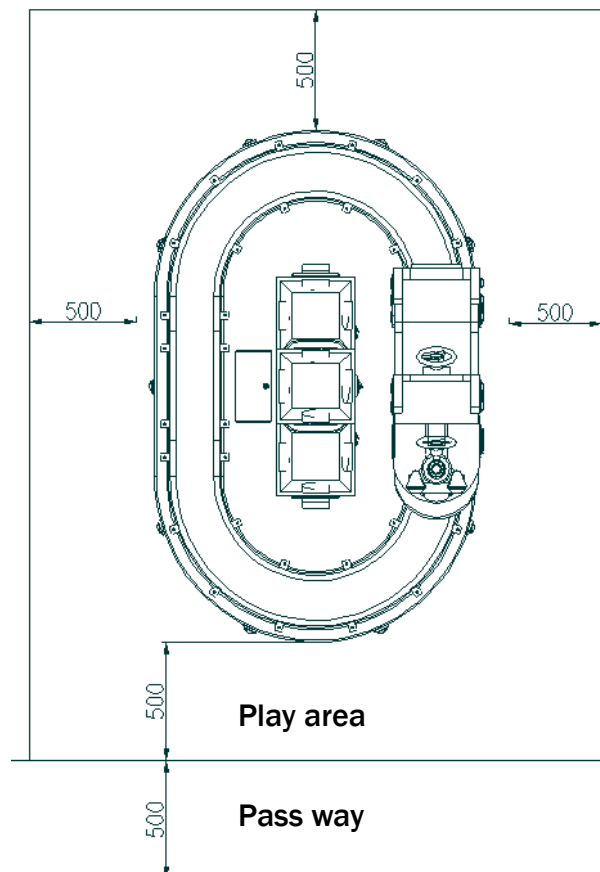

4.3 Level Adjustment

Install this machine on a flat surface. Adjust levers to lift casters off the ground to level the game. If the game is installed on an unsuitable floor, it could cause game malfunction.

To secure the game, adjust the Leveler down until it touches the floor, lifting the casters off the ground by 5mm. Repeat the same for all levelers.

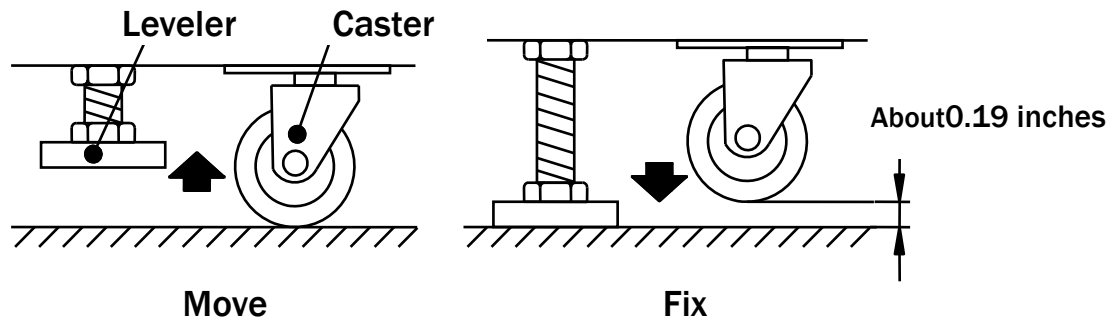

NOTICE

Make sure the machine is level with the ground and all the adjustable legs should stick to the floor closely.

4.4 Transporting the Game

If you need to move the game, adjust the levelers back to an “up” position so the casters touch the ground.

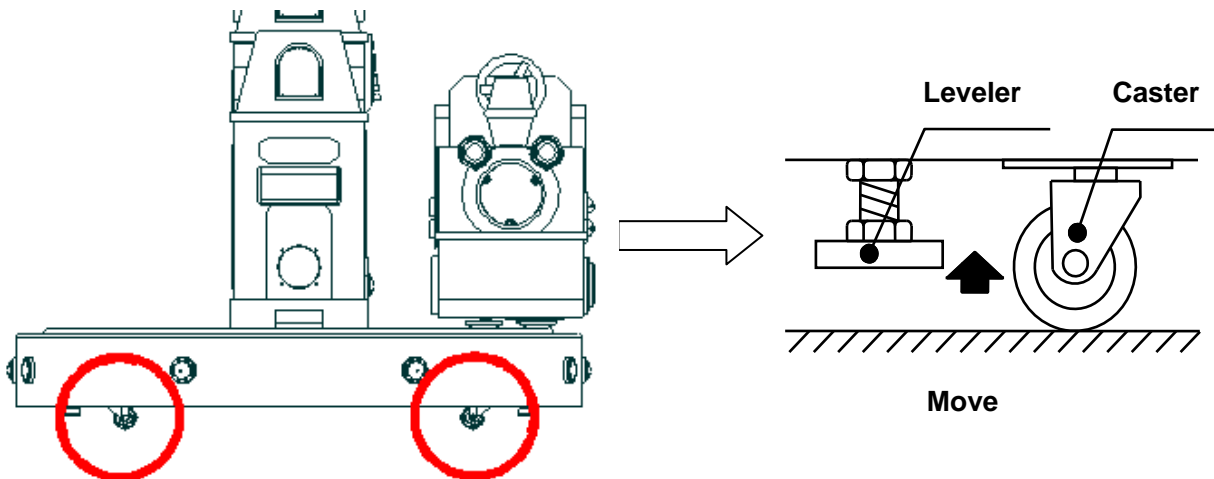

! NOTICE

- Be careful not to damage the machine during transport.
- The machine should be handled with care when bringing it down from a higher level.
- Always unplug the game before moving.
- Keep the machine in upright position during transport.
- For longer distance transport, package the game properly to prevent damages.

4.5 Connecting Power

! **WARNING:** Check the voltage rating before you connect the equipment to an electrical outlet to ensure that the required voltage and frequency match the available power source. Please refer the label of the machine.

- Do not plug the equipment power cables into an electrical outlet if the power cable is damaged.
- Avoid putting many loads on one electrical outlet as it could generate heat and fire resulting from overload.
- Connect the grounding conductor to the earth terminal (GND):

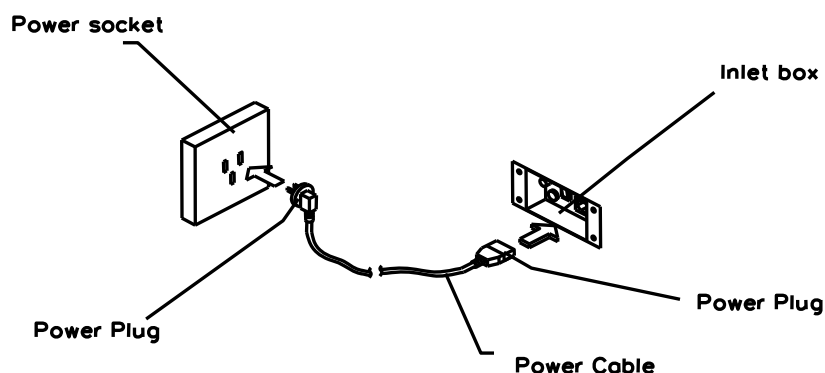



WARNING

Ensure no heavy objects rest on the power cord. Check to make sure the game cabinet does not sit on the power cord as this could damage the cord and become hazardous.

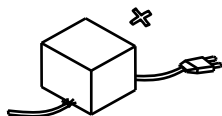

To disconnect the game, grip the plug and pull it from the wall outlet. Never pull by the cord.

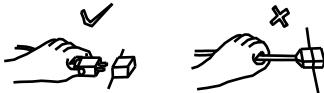

To prevent electric shock, do not touch the power plug when hand is wet.



Ensure that nothing rests on the power cord and that it is not located where it can be stepped on or tripped over.



5. HOW TO PLAY

1. Seat on the train and fast the seat belt.
2. Insert a coin the game is about to start.
3. The train begins to drive slowly around the track. Press the stop button during the game can have the train stopped. Press the stop button again, the train begins to drive again.
4. Music is stop and the game is over.

6. GAME OPTIONS

6.1 IO Chart

Refer to the attached I/O chart. The initial setting is in CAPITAL LETTER.

(1) DIP SW1

Item	Content	DIP Adjust (SW1)	
		1	2
Coin per game	1	ON	ON
	2	off	on
	3	on	off
	4	off	off

(2) DIP SW1

Item	Content	DIP Adjust (SW1)		
		3	4	5
Lay per game	1	on	on	on
	2	OFF	ON	ON
	3	on	off	on
	4	off	off	on
	5	on	on	off
	6	off	on	off
	7	on	off	off
	8	off	off	off

(3) DIP SW1

Item	Content	DIP Adjust (SW1)
		8
Demo	ON	on
Music	OFF	OFF

(4) MB-15W408AD Train Station DIP SW

Item	Content	SW SETTING			
		SW1	SW2	SW3	SW4
Part	Train	on			
	Train station	OFF			
Address	1		ON	ON	ON
	2		off	on	on
	3		on	off	on
	4		off	off	on
	5		on	on	off
	6		off	on	off
	7		on	off	off
	8		off	off	off

Note: Please set the train and the train station in a same address as a set. If there is more than 1 game in a location, please set in different address to every machine.

(5) MB-15W408AD Train DIP SW

Item	Content	SW SETTING			
		SW1	SW2	SW3	SW4
Part	Train	ON			
	Train Station	off			
Address	1		ON	ON	ON
	2		off	on	on
	3		on	off	on
	4		off	off	on
	5		on	on	off
	6		off	on	off
	7		on	off	off
	8		off	off	off



Notice

The above are subject to change without notice.

6.2 ERROR CODE:

If any input single isn't normal, display error code, pass after alarm several times

Error Code	Potential cause	Solution
E1	Coin mech. error	Check the wiring or replace with a proper coin mech.
E2	Test button error	Replace with proper test button.
E3	Initial position sensor error	Replace with a new home switch.
E5	Sensor 1 error	Adjust the knob at the end of the sensor or replace with a new one on the head of the train.
E6	Sensor 2 error	Adjust the knob at the end of the sensor or replace with a new one on the head of the train.

7. MAINTENANCE, INSPECTION

7.1 Safety Check

Check the points listed before operating the machine. These checks are necessary for safe machine operation:

1. Try to run the game before operation each day.
2. Conduct monthly routine checks of game components ensure good working condition
3. Check the machine regularly for dust and clean when necessary.

Note: Parts and components require preventative maintenance to be kept running smoothly

7.2 Handling Precautions

When installing or inspecting the machine, be very careful of the following points and pay attention to ensure that the player can enjoy the game safely.

Non-compliance with the following points or inappropriate handling running counter to the cautionary matters herein stated can cause personal injury or damage to the machine



WARNING

- Before servicing the machine, be sure to turn power off. Servicing without turning the power off can cause electric shock or short circuit.
- To avoid electric shock or short circuit, do not plug then unplug the power quickly
- Do not expose power cords and earth wires, these are susceptible to damage.
- Damaged cords and wires can cause electric shock or short circuit and should be replaced immediately.
- When or after installing the product, avoid pulling the power cord to prevent unnecessary wear and tear. Use the power button to disconnect power.
- In case the power cord is damaged, ask for replacement through where the product was purchased from or replace locally. Continued usage of damaged cord can cause fire, electric shock or leakage.
- Perform grounding appropriately. Inappropriate grounding can cause electric shock.
- Use fuses that meet specified rating. Fuses exceeding can cause an electric shock.
- Should a problem occur, turn off the power immediately and stop operating the machine. Unplug the power cord of the service outlet. Operating the machine without correcting the problem may cause a fire or injuries.
- Insert the power plug securely into the outlet. Poor contact may cause overheating, resulting in fire or burns.
- To ensure the warning labels attached on the machine are visible and legible, install the machine in a well-lit location, and keep the labels clean at all times. Make sure the labels are not hidden behind other game machines.

8. OVERALL CONSTRUCTION

8.1 Base Part

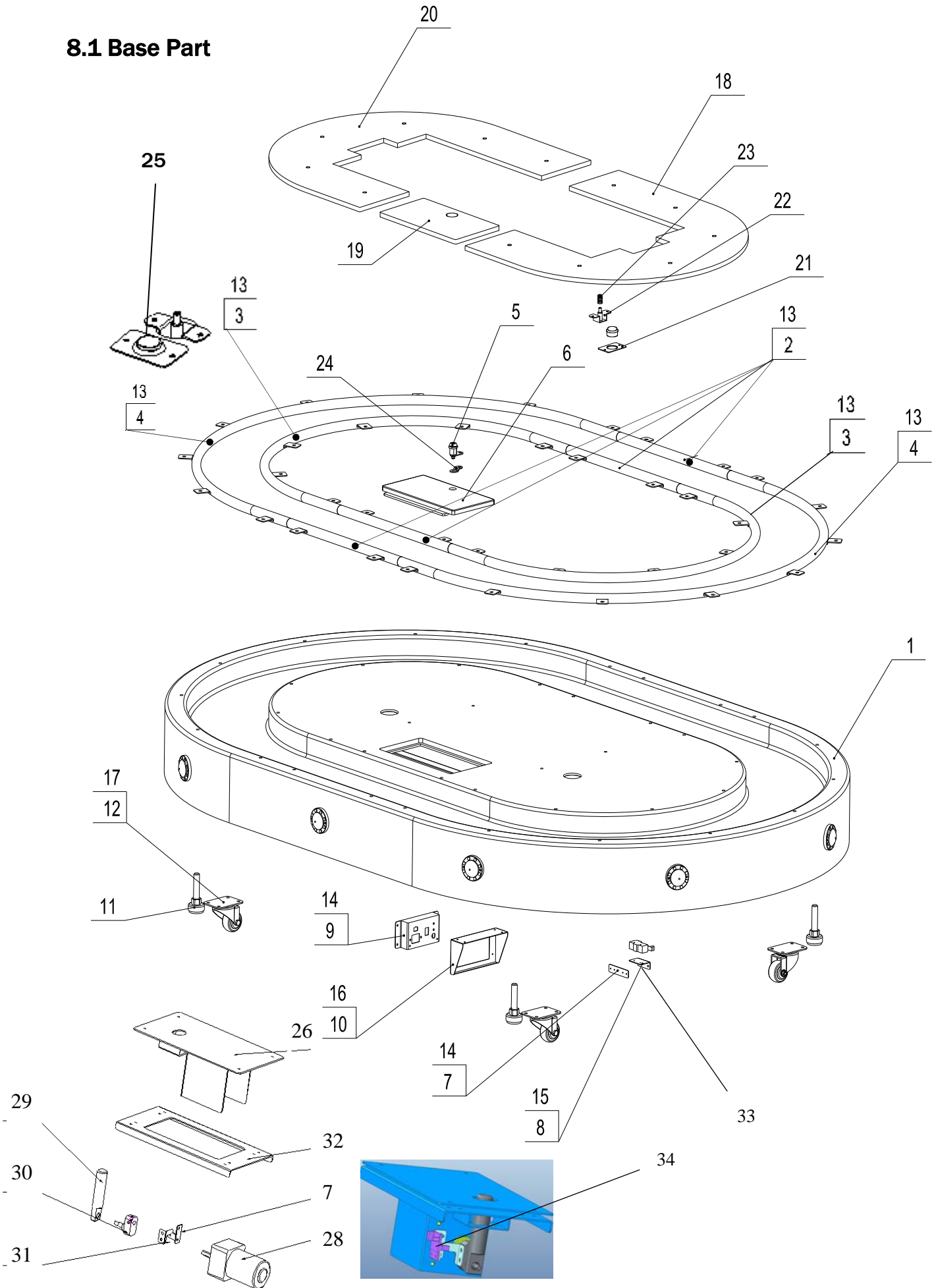

No.	Part No.	Code No.	Name	Material	Qty.
1	C135-002-000	(CEC)GDXHC-01-01	Base Assembly	Assembly	1
3	C135-119-000	20251303005	Inner rail (curve)	Mirror steel201	2
4	C135-120-000	20251303006	Outer rail (curve)	Mirror steel201	2
5	C135-443-000	25300000004	Lock	C582	1
6	C135-003-000	GDXHC-01-02	Base door Assy.	Assembly	1
7	C135-196-000	20651303A007	Magnet Base	Black PVC	1
8	C135-195-000	20651303A006	Magnetic switch base	Clear PVC	1
9	C135-167-000	26000042001	Power box	Metal	1
10	C135-121-000	20251303007	Outlet bracket	Metal	1
11	C135-165-000	20241013042	Leveller	Q235	4
12	C135-444-000	25501000056	Caster	3-2689-52	4
13	C135-312-000	20104100030	Hexagon bolt	Stainless steel	36
14	C135-323-000	20101020040	Cross recessed pan head bolt suite	Q235	6
15	C135-324-000	20101020034	Cross recessed pan head bolt suite	Q235	2
16	C135-325-000	20101020036	Cross recessed pan head bolt suite	Q235	4
17	C135-318-000	20104020003	Cross recessed hexagon head kit screws	Q235	16
18	C135-508-000	(CEC)GDXHC-01-06M	Pedal plate A	δ12	1
19	C135-510-000	(CEC)GDXHC-01-08M	Pedal plate C	δ12	1
20	C135-509-000	(CEC)GDXHC-01-07M	Pedal plate B	δ12	1
21	C135-101-000	(CEC)GDXHC-01-03	Button plate	Metal	10
22	C135-102-000	(CEC)GDXHC-01-04	Spring plate	δ1.5	12
23	C135-103-000	(CEC)GDXHC-01-05	Pedal spring	Φ2	12
24	C135-146-000	(CEC)GDXHC-01-09	Door lock tip	C582	1
25	C135-406-000	22401000081	Orange button	Orange	10
26	C135-175-000	20251303A021	Lock base	δ2	1
27	C135-176-000	20251303A020	Lock bed plate	δ2	1
28	C135-455-000	23404000054	DC motor	55zy12-25-02/ 60JB100G0832	1
29	C135-173-000	20251303A023	Safety pin	Φ20 black	1
30	C135-174-000	20251303A022	Lock shaft	black	1
31	C135-172-000	20251303A024	Initial position plate	δ1	1
32	C135-171-000	20251303A025	Sensor mounted plate	δ1.5	1
33	C135-466-000	22601000007	Magnetic switch	GPS-30L	1
34	C135-182-000	29710701003	Sensor board	Sensor MOC70T4.PCBV1.1	1

For Straight rail, there are two versions (different length), please refer to your machine to find the version you need.

2	C135-118-001	20251303004	Straight rail	Mirror steel201 (19.88 in)	4
2	C135-118-000	20251303004	Straight rail	Mirror steel201 (19.29 in)	4

8.2 Train Part

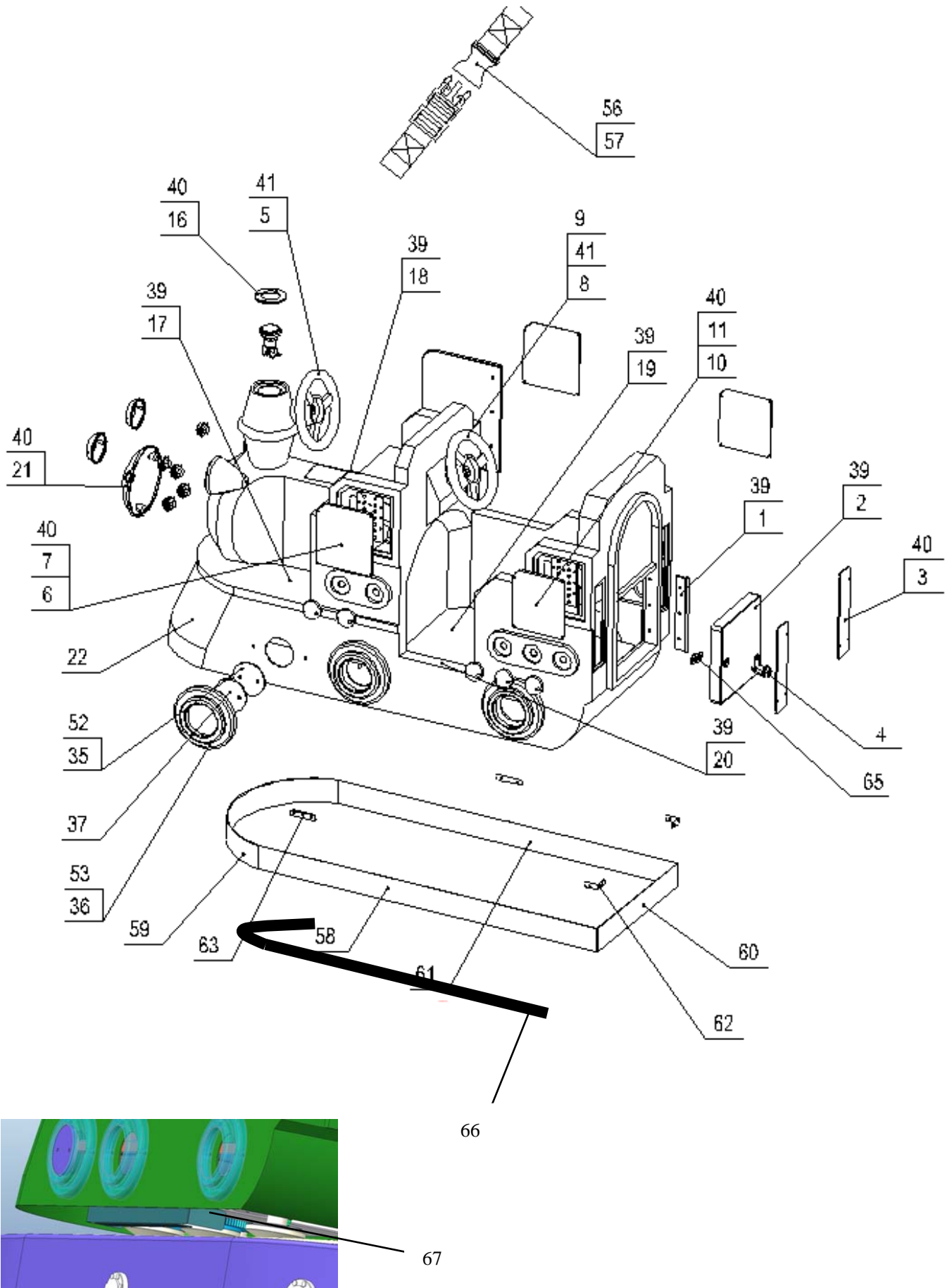

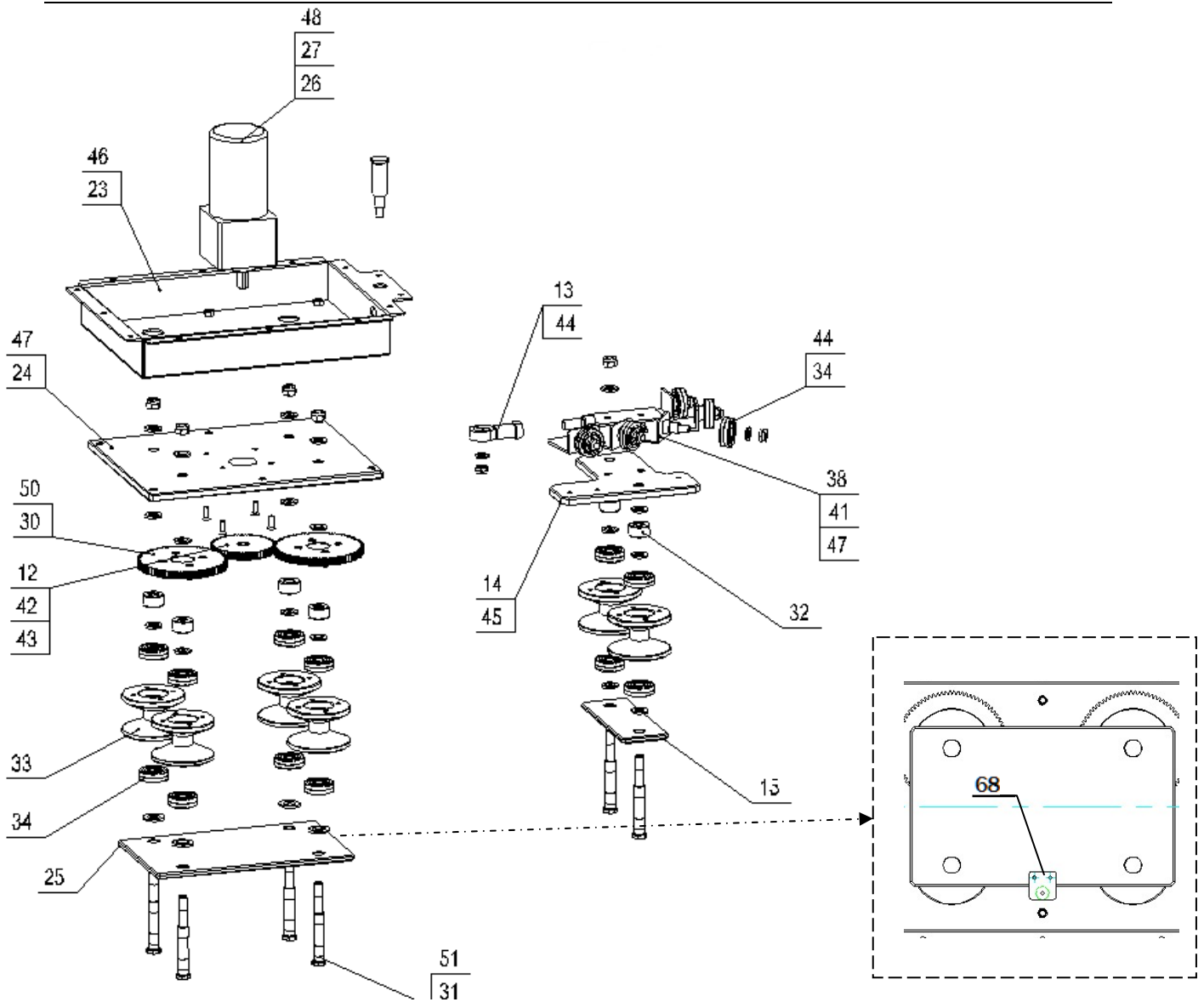

No.	Part No.	Code No.	Name	Material	Qty.
1	C135-140-000	20251303022	Door short hinge	Q235	1
2	C135-004-000	GDXHC-02-02	Train door assy.	Assembly	1
3	C135-722-000	20551303A022	Train back strip plastic	Clear plastic	2
4	C135-443-000	25300000004	Lock	C582	1
5	C135-446-000	41106000018	Red steering wheel	Φ170redW-045	1
6	C135-701-000	(CEC)GDXHC-HM-01	Front seat left side decal	Clear plastic	1
7	C135-702-000	(CEC)GDXHC-HM-02	Front seat right side decal	Clear plastic	1
8	C135-447-000	41106000019	Green steering wheel	Φ170greenW-045	1
9	C135-141-000	20651303010	Small shaft sleeve	White nylon	2
10	C135-703-000	(CEC)GDXHC-HM-03	Back seat left side decal	Clear plastic	1
11	C135-704-000	(CEC)GDXHC-HM-04	Back seat right side decal	Clear plastic	1
12	C135-136-000	20251303018	Driver wheel	45#	1
13	C135-439-000	20106080153	Rod end oscillating BD.	SI14T/K M14×2	1
14	C135-137-000	20651303008	Top plate	PP plate	1
15	C135-138-000	20651303009	Small bed plate	PP plate	1
16	C135-747-000	20551303A020	Button plate decal		1
17	C135-144-000	20251303024	Foot plate B	Aluminum Plate	1
18	C135-177-000	20251303A027	Right foot plate	Aluminum plate	1

No.	Part No.	Code No.	Name	Material	Qty.
19	C135-143-000	20251303023	Foot plate A	Aluminum plate	1
20	C135-710-000	(CEC)GDXHC-HM-10	Pedal panel	202Stainlessl	1
21	C135-142-000	20651303011	Train head big light cover	White plastic	1
22	C135-005-000	GDXHC-02-01	Train Assy.	Assembly	1
23	C135-104-000	(CEC)GDXHC-02-02	Train base panel	Q235	1
24	C135-130-000	20651303005	Motor bed plate	PP plate	1
25	C135-133-000	20651303007	Bottom bed plate	PP plate	1
26	C135-441-000	23404000090	DC motor		1
27	C135-442-000	23404000091	Gearbox		1
28	C135-505-000	20351303005	Sliding base plate	Plywood	1
29	C135-139-000	20251303021	Sliding panel	Metal	1
30	C135-135-000	20251303017	Driven wheel	Oil Nylon(MC901)	2
31	C135-134-000	20251303016	Roller shaft	45#	6
32	C135-132-000	20651303006	Shaft sleeve	White nylon	6
33	C135-131-000	20251303015	Rolling wheel	45#	6
34	C135-438-000	20106000049	Deep groove ball BD.		17
35	C135-148-000	20251303027	Train wheel light plate	Metal	3
36	C135-170-000	26000057001	Speaker grill light cover	Clear PC	3
37	C135-149-000	20651303013	Train wheel light loodlighting plate	PVC	3
38	C135-105-000	(CEC)GDXHC-02-03	Oscillating deck	Q235	1
39	C135-308-000	20111000007	Flat round head blind rivet	4×16	20
40	C135-331-000	20103000009	Cross recessed screw		29
41	C135-301-000	20102030023	Nonmetal hexagon lock nut	Q235	4
42	C135-315-000	20101100085	Hexagon round head screw	M5×20	2
43	C135-310-000	20102020030	Hexagon nut with flange	Q235	2
44	C135-302-000	20102000001	Nonmetal hexagon lock nut		6
45	C135-326-000	20101020042	Cross recessed pan head bolt suite	Q235	3
46	C135-303-000	20102030003	Nonmetal hexagon lock nut	Q235	7
47	C135-313-000	20104040030	Hexagon bolt		8
48	C135-317-000	20101102013	Cross recessed sunk head screw		4
49	C135-327-000	20101020111	Cross recessed pan head bolt suite	Q235	5

No.	Part No.	Code No.	Name	Material	Qty.
50	C135-316-000	20101100173	Hexagon round head screw		8
51	C135-304-000	20102000041	Nonmetal hexagon lock nut	Q235	6
52	C135-332-000	20103100006	Cross recessed pan head self-tapping screw		12
53	C135-314-000	20101000161	Hexagon flat round head screw		12
54	C135-150-000	GDXHC-02-26	Power supply plate	Metal	1
55	C135-335-000	20101020159	Cross recessed pan head bolt suite	Q235	4
56	C135-163-000	20240836046	Seat belt buckle		4
57	C135-106-000	20651303A002	Seat belt	Black	2
58	C135-108-000	20251303A008	Left brush	Brush	1
59	C135-107-000	20251303A007	Front brush	Brush	1
60	C135-110-000	20251303A010	Back brush	Brush	1
61	C135-109-000	20251303A009	Right brush	Brush	1
62	C135-112-000	20251303A012	Brush fixed plate B	Q235	2
63	C135-111-000	20251303A011	Brush fixed plate A	Q235	5
64	C135-336-000	20111000018	Flat round head blind rivet	Q235	14
65	C135-146-000	20251303A004	Door lock tip	C582	1
66	C135-178-000	20651303A005	Outside inner shield	Black PVC	1
67	C135-183-000	20251303043	Gear protected plate	Q235	1
68	C135-467-000	20241032049	Magnet	B822	2
	C135-196-000	20651303A007	Magnet Base	Clear PVC	1

8.3 Fiberglass Part

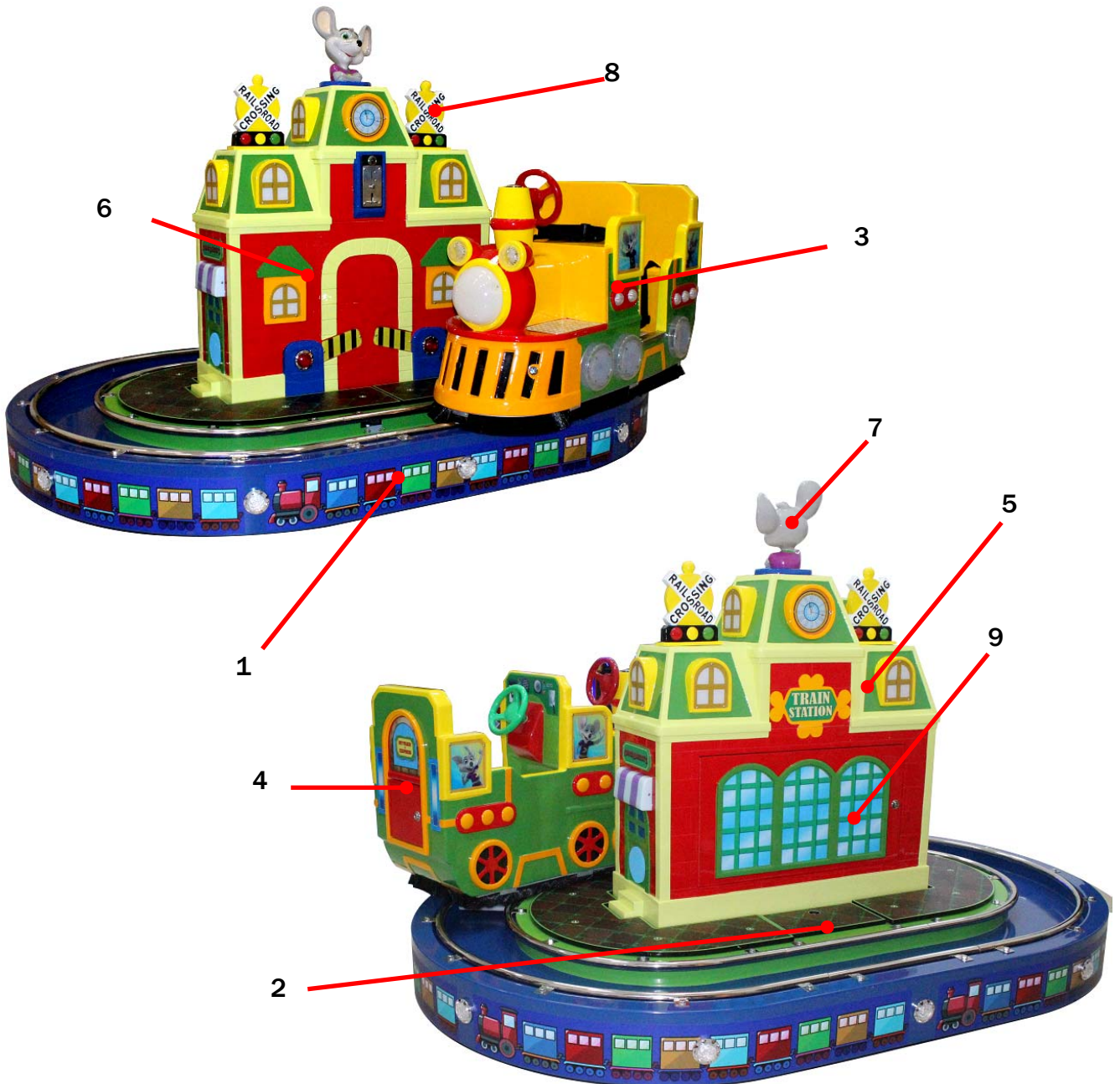

No.	Part No.	Code No.	Name	Material	Qty.
1	C135-601-000	(CEC)GDXHC-01-01-1	Base fiberglass	Fiberglass	1
2	C135-602-000	(CEC)GDXHC-01-02-1	Base door fiberglass	Fiberglass	1
3	C135-603-000	(CEC)GDXHC-02-01-1	Train fiberglass	Fiberglass	1
4	C135-604-000	20651303004	Train door fiberglass	Fiberglass	1
5	C135-606-000	20451303A004	Station upper fiberglass	Fiberglass	1
6	C135-605-000	20451303A003	Station bottom fiberglass	Fiberglass	2
7	C135-608-000	(CEC)GDXHC-03-04-1	Character fiberglass	Fiberglass	1
8	C135-607-000	20451303A005	Traffic light fiberglass	Fiberglass	2
9	C135-609-000	20651303015	Station door fiberglass	Fiberglass	1

No.	Part No.	Code No.	Name	Material	Qty.
21	C135-721-000	20551303008	Right bar plastic	Clear plastic	1
22	C135-720-000	20551303007	Left bar plastic	Clear plastic	1
23	C135-156-000	20251303033	Bar fixed plate	Metal	4
24	C135-333-000	20103100009	Cross recessed pan head self-tapping screw	Stainless steel	40
25	C135-321-000	20101100023	Cross recessed pan head screws	Stainless steel	2
26	C135-308-000	20111000007	Flat round head blind rivet		10
27	C135-311-000	20102020011	Hexagon nut with flange	Q235	20
28	C135-328-000	20101020035	Cross recessed pan head bolt suite	Q235	18
29	C135-326-000	20101020042	Cross recessed pan head bolt suite	Q235	6
30	C135-329-000	20101000186	Cross recessed pan head bolt suite	Q235	6
31	C135-322-000	20101100021	Cross recessed pan head screws	Stainless steel	4
32	C135-605-000	(CEC)GDXHC-03-02	Station upper fiberglass	Fiberglass	1
33	C135-008-000	(CEC)GDXHC-03-03	Traffic light assy.	Assembly	2
34	C135-009-000	(CEC)GDXHC-03-04	Character assy.	Assembly	1
35	C135-337-000	20101020037	Cross recessed pan head bolt suite	Q235	4
36	C135-431-000	29740803012	Clock LED light board	HHXYS-LED01.PCB (V1.0)white	2

8.5 Electrical Part

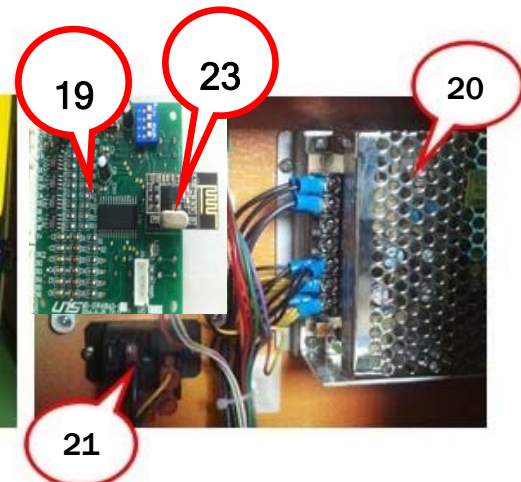
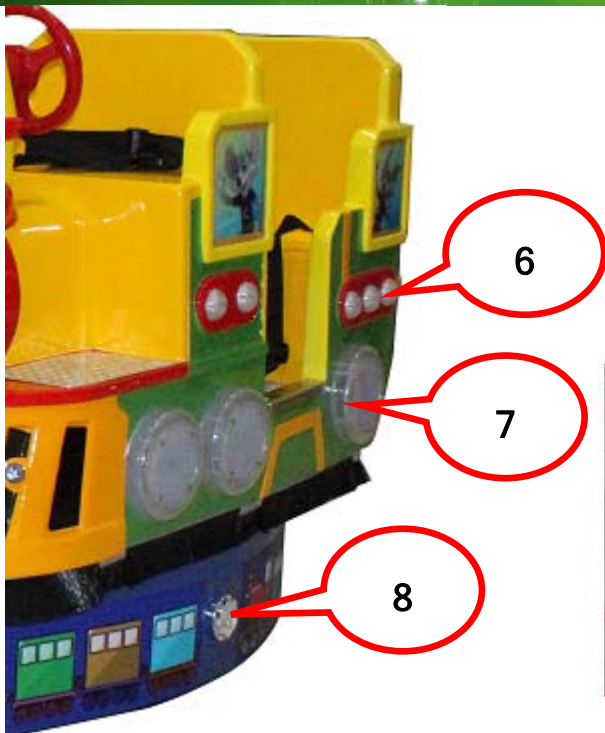
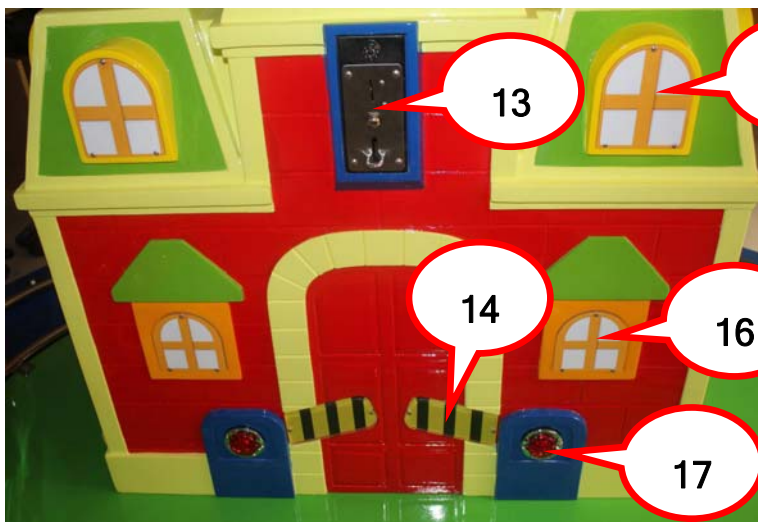
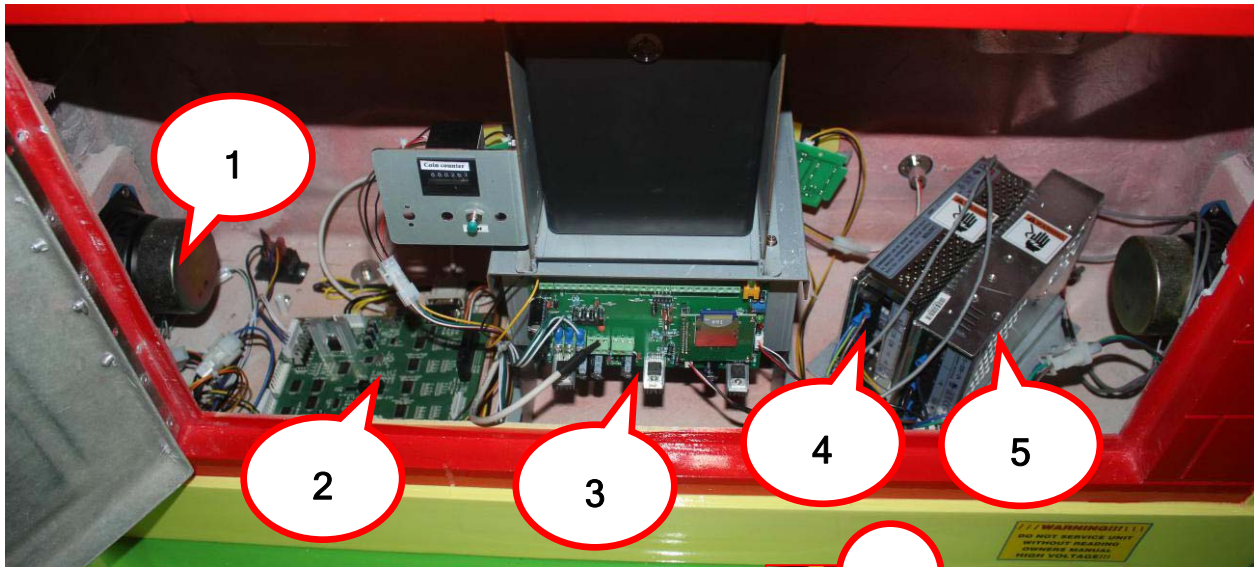

26



No.	Part No.	Code No.	Name	SPEC.	Qty.
1	C135-415-000	22801000005	Speaker	4"4Ω15W	2
2	C135-401-000	21701000006	Main board	V12-MB.PCB Ver1.3	1
3	C135-436-000	21702000021	Sound board	1G SD card	1
4	C135-404-000	21602000094	Power supply	EPT-S150S12(12V/12.5A)	1
5	C135-405-000	21602000095	Power supply 2	EPT-S320S24	1
6	C135-424-000	22003020004	Train side light	JY00041/clear cover DC12V	5
7	C135-425-000	22002016011	Train wheel light board	JY-RGB-27	3
8	C135-423-000	22003060007	Base side light	JY00190/DC12V clear cover	10
9	C135-418-000	22401030006	Stop button	White	1
10	C135-426-000	22204060004	Head light cover	JY207 clear cover	2
11	C135-430-000	29710914005	Train head big light	HHXYS-LED01.PCB(V1.0) blue	1
12	C135-429-000	21501000047	Train head sensor	SZ-GY-50FKS1	2
13	C135-416-000	22301000029	Coin mech.	HS-07CS	1
14	C135-428-000	22003030002	Brake handle light	E10 DC12V flash LED	2
15	C135-417-000	29741003001	Window light board	HHXYS-LED02.PCB(V1.0) white	8
16	C135-421-000	29751303001	Bottom window LED light board	GDXHC-LED.PCB(V1.0)	10
17	C135-427-000	22003060008	Gate block light	JY00190/DC12V red light red cover	2
18	C135-422-000	29711205003	Train back light board	LED48NC.PCB(15 white)	2
19	C135-402-000	29751303002	Small PCB	TKC-DISP.PCB	1
20	C135-435-000	21602020002	Power box	24DEP-45S12	1
21	C135-403-000	22140012007	Relay	12V-T9AP5D52-12	2
22	C135-432-000	22201000023	Long tail light socket	E10	2
23	C135-440-000	21107240001	2.4G wireless module	NRF24L01	2
24	C135-420-000	22003000006	LED bulb	LED(12V) white JA-T810	1
25	C135-419-000	22604000006	Micro SW	BLM-S 3A-125/250VAC	1
26	C135-468-000	22606070001	Tape switch		1

8.6 Counter & Wire box:

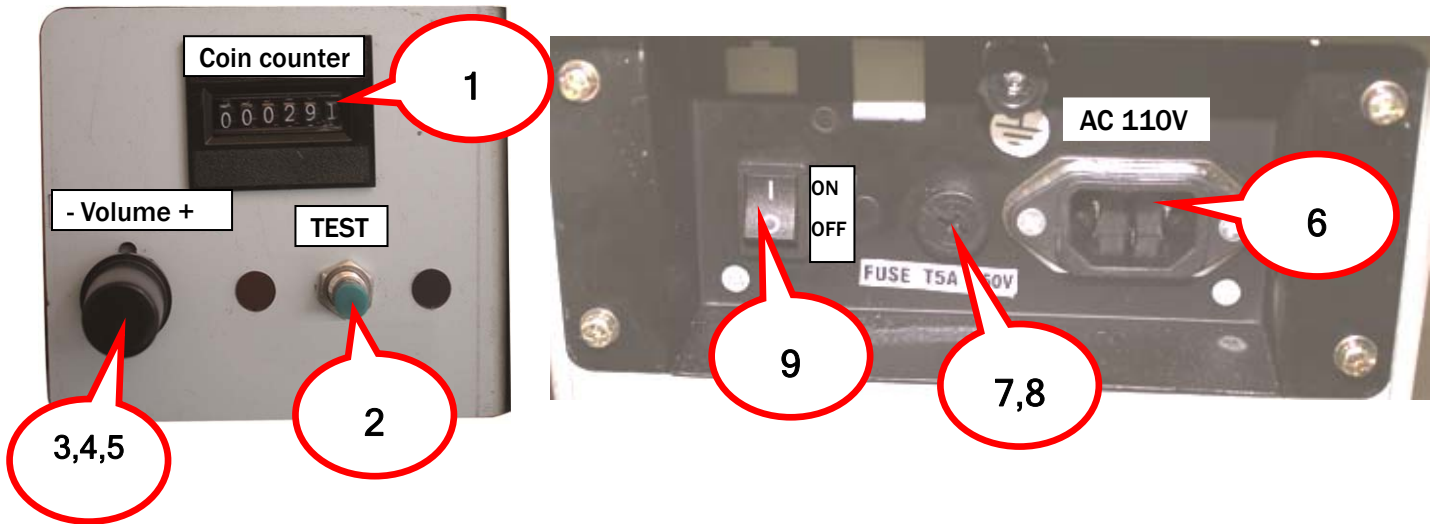

No.	Part No.	Code No.	Name	SPEC.	Qty.
1	C135-408-000	23000000006	Coin Counter	C-012 12VDC 18CPS	2
2	C135-407-000	22402050001	Test button	PB:11C02R(black)	1
3	C135-413-000	22403000001	POT knob	Black	1
4	C135-433-000	22501000006	POT	10K	1
5	C135-434-000	21709000002	POT connected board	VR.PCB	1
6	C135-409-000	23201000001	Filter with switch	YB10A1 10A/250V	1
7	C135-410-000	21902000006	Fuse socket	R3-11 110V/250V/10A	1
8	C135-411-000	21901000012	Fuse	Φ5×20mmT5A C250VAC	1
9	C135-412-000	22601000005	Rocket SW	T125/55	1

8.7 Game Decals:

View A:

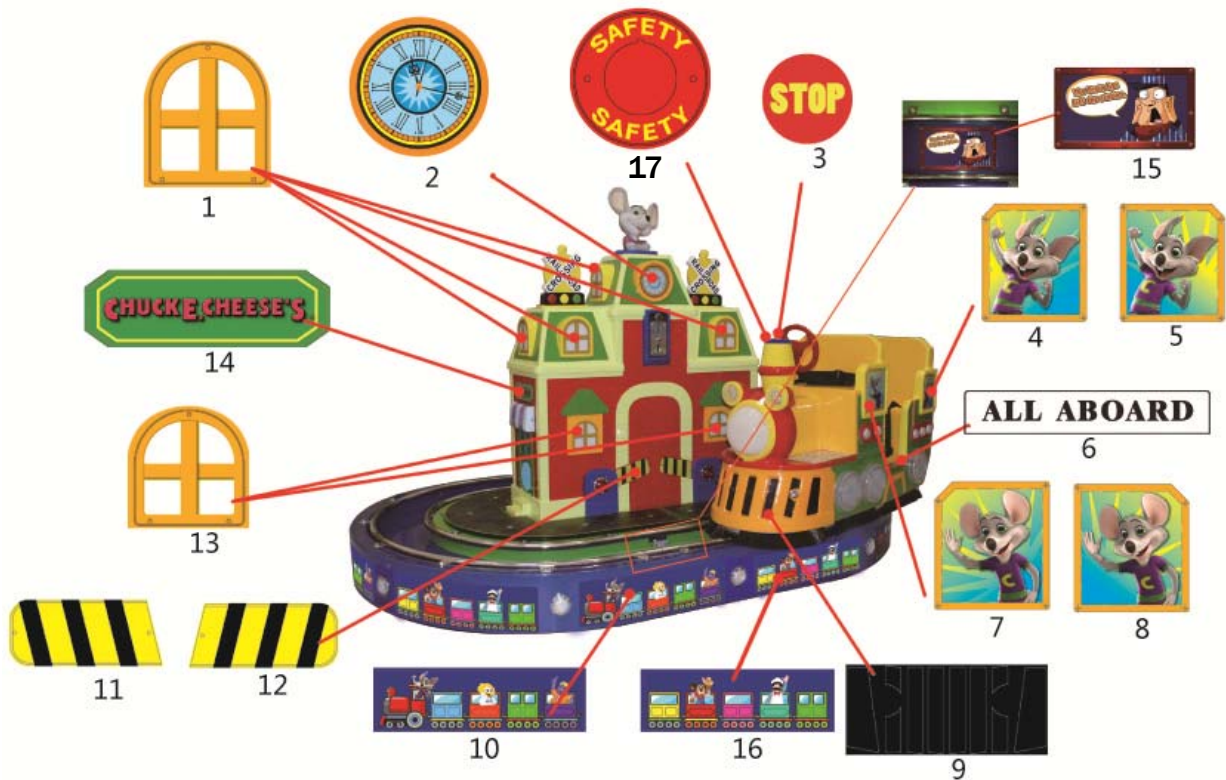

No.	Part No.	Code No.	Name	Material	Qty.
1	C135-723-000	20551303A023	Big window plastic	Clear plastic	8
2	C135-718-000	20551303A021	Clock plastic	Clear plastic	2
3	C135-709-000	20551303A009	Stop button decal	PVC100u Sticker	1
4	C135-703-000	20551303A003	Back seat left side decal	Clear plastic	1
5	C135-704-000	20551303A004	Back seat right side decal	Clear plastic	1
6	C135-710-000	20551303A010	Pedal panel	202Stainlesssteel	1
7	C135-701-000	20551303A001	Front seat left side decal	Clear plastic	1
8	C135-702-000	20551303A002	Front seat right side decal	Clear plastic	1
9	C135-711-000	20551303A011	Train head decal	PVC100u Sticker	1
10	C135-748-000	20551303A018	Base side decal A		5
11	C135-721-000	20551303008	Right bar plastic	Clear plastic	1
12	C135-720-000	20551303007	Left bar plastic	Clear plastic	1
13	C135-724-000	20551303A024	Small window plastic	Clear plastic	2
14	C135-705-000	20551303A005	Logo decal	Reversed screen PVC	2
15	C135-750-000	20551303A027	Rail bed decal	Reversed screen PVC	1
16	C135-749-000	20551303A019	Base side decal B		5
17	C135-747-000	20551303A020	Button plate decal		1

View B :

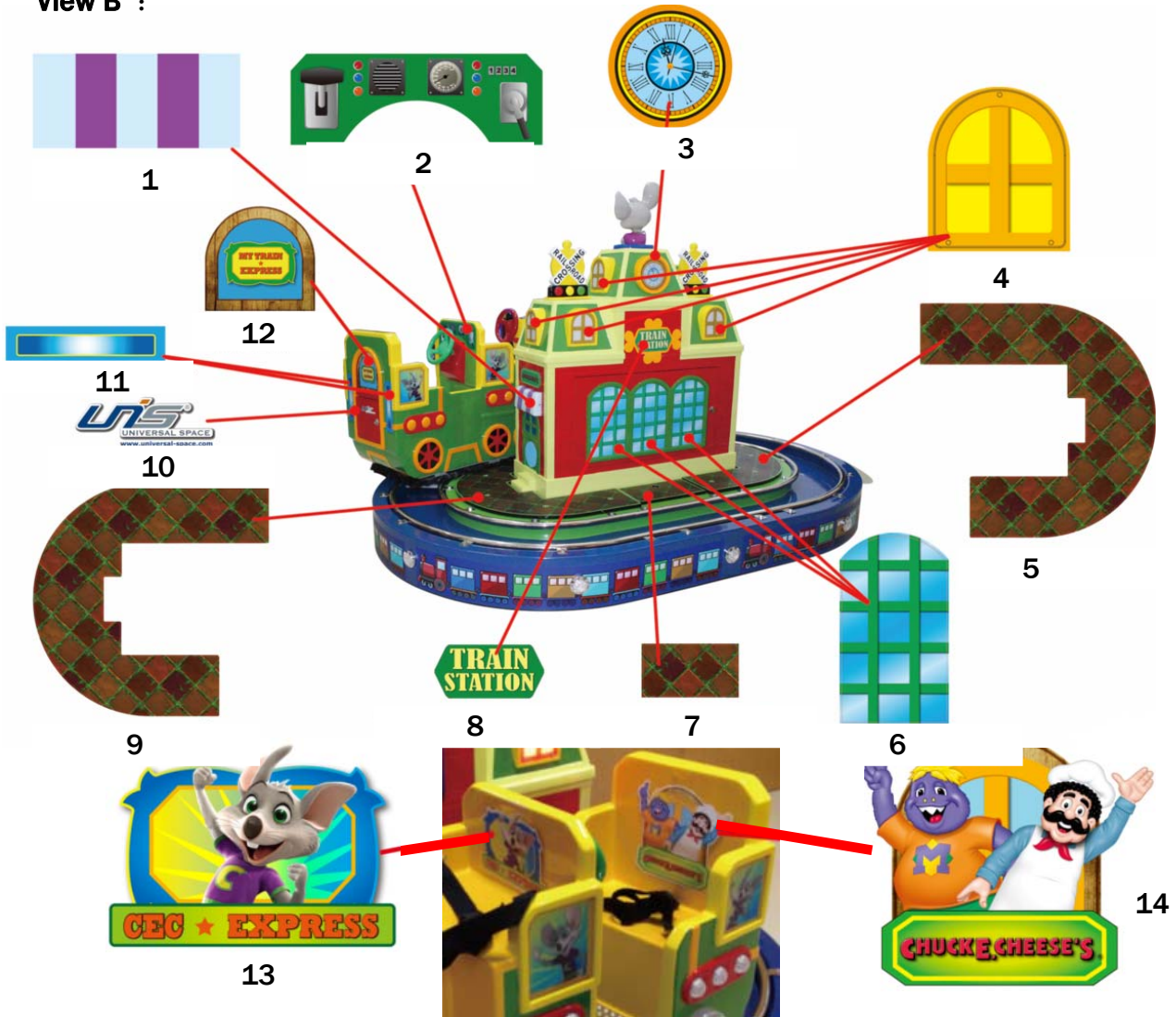

No.	Part No.	Code No.	Name	Material	Qty.
1	C135-719-000	20551303006	Shed plastic	vacuum foam	2
2	C135-707-000	20551303A007	Train panel decal	Reversed screen	1
3	C135-718-000	20551303A021	Clock plastic	Clear plastic	2
4	C135-723-000	20551303A023	Big window plastic	Clear plastic	8
5	C135-714-000	20551303A014	Pedal plate decal B	Reversed screen PVC	1
6	C135-725-000	20551303012	Door plastic	Reversed screen PVC	3
7	C135-715-000	20551303A015	Pedal plate decal C	Reversed screen PVC	1
8	C135-706-000	20551303A006	Train station decal	Reversed screen PVC	1
9	C135-713-000	20551303A013	Pedal plate decal A	Reversed screen PVC	1
10	C135-712-000	20551303A012	UNIS logo	Clear Sticker	1
11	C135-722-000	20551303A022	Train back strip plastic	Clear plastic	2
12	C135-708-000	20551303A008	Train back door decal	Reversed screen PVC	1
13	C135-745-000	20551303A025	Seat back decal 1	Reversed screen	1
14	C135-746-000	20551303A026	Seat back decal 2	Reversed screen	1

Labels:

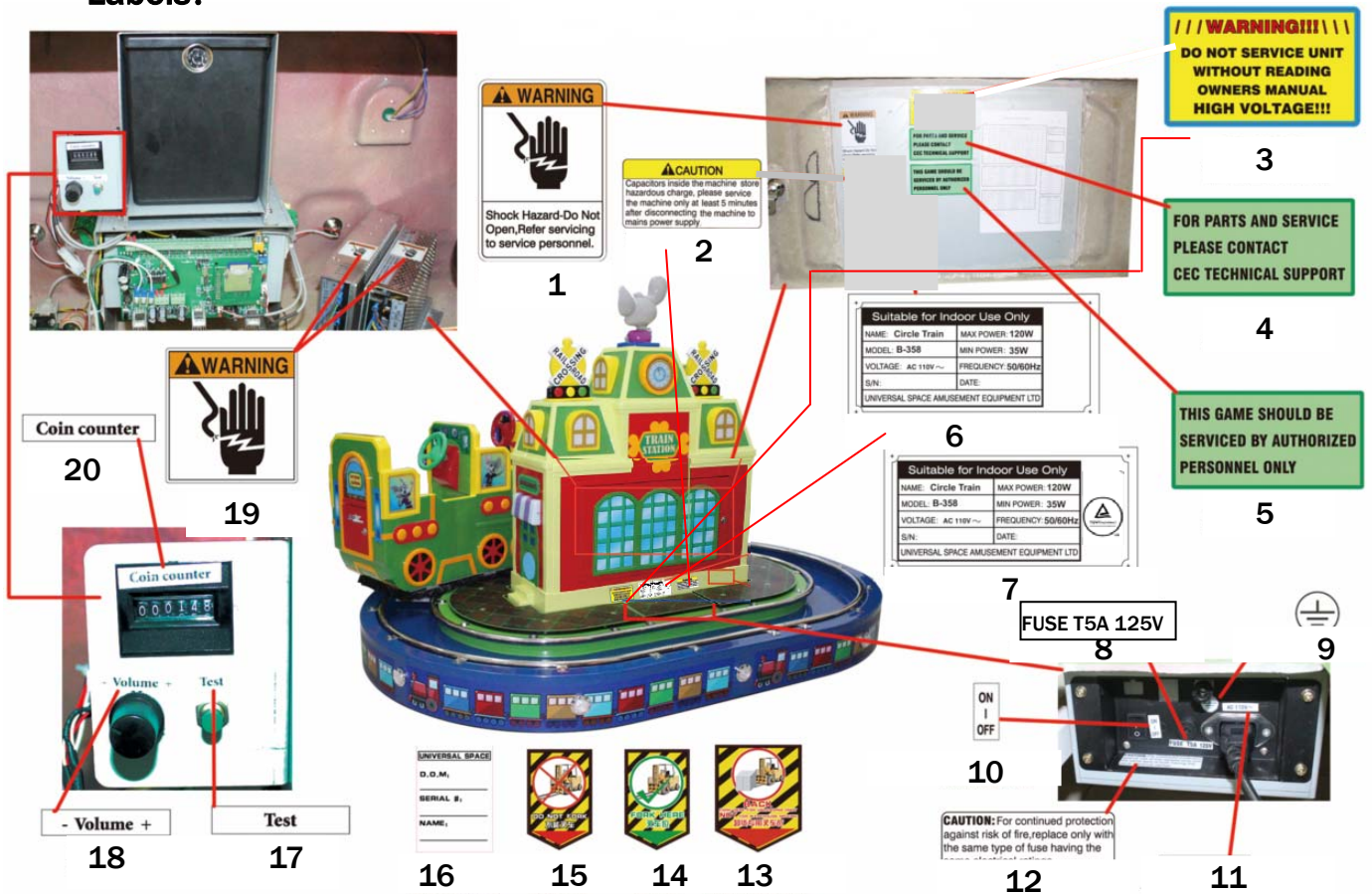

No.	Part No.	Code No.	Name	Material	Qt
1	C135-735-000	25600000085	Warning label -L	PVC100u Sticker	2
2	C135-736-000	25600000086	Capacity discharge label	PVC100u Sticker	1
3	C135-740-000	25600000067	Service label	PVC100u Sticker	1
4	C135-739-000	25600000043	Service label 2	PVC100u Sticker	1
5	C135-738-000	25600000042	Service label 1	PVC100u Sticker	1
6	C135-716-000	20551303A016	Uncertified 10V name	1mm PVC	1
7	C135-717-000	20551303A017	TUV Name plate	1mm PVC	1
8	C135-733-000	25600000080	Fuse label	PVC100u ticker	1
9	C135-730-000	25600000091	GND label	PVC100u sticker	1
10	C135-731-000	25600000017	Power SW label	PVC100u Sticker	1
11	C135-732-000	25600000071	110V label	PVC100u Sticker	1
12	C135-737-000	25600000087	Fuse warning label	PVC100u Sticker	1
13	C135-744-000	25600000066	Unload decal	PVC100u Sticker	1
14	C135-743-000	25600000065	Fork decal	PVC100u Sticker	1
15	C135-742-000	25600000064	No Fork decal	PVC100u Sticker	1
16	C135-741-000	25600000063	Packing label	PVC100u Sticker	1
17	C135-729-000	25600000005	Test button label	PVC100u Sticker	1
18	C135-728-000	25600000003	Vol. label	PVC100u Sticker	1
19	C135-734-000	25600000036	Warning label -s	PVC100u Sticker	4
20	C135-727-000	25600000001	Coin counter label	PVC100u Sticker	1

8.8 Updated Parts



No.	Part No.	Code No.	Name	Material	Qty.
1	C135-460-000	20251303A029	Pedal plate D	δ3.0 green	1
2	C135-751-000	20551303A031	Pedal plate D decal	PVC	1
3	C135-189-000	20251303A030	Button pad	Metal	6

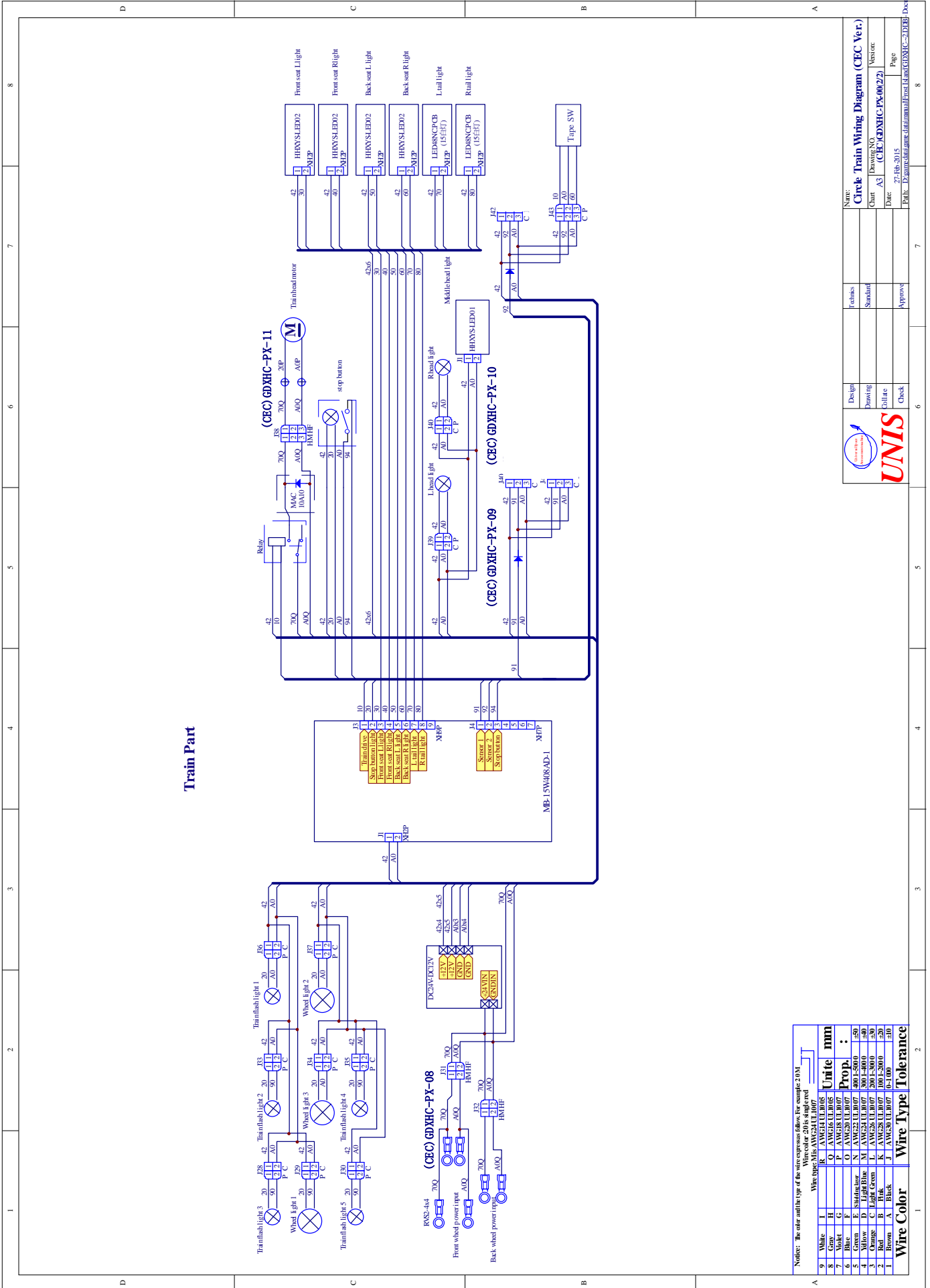

Train Part

Notes: The order and the type of the wire express follow for example 2DM
 Wire type: AWG25UL1007

Wire Color	Wire Type	Wire Tolerance
0	White	±10
1	Black	±10
2	Red	±10
3	Green	±10
4	Blue	±10
5	Brown	±10
6	Pink	±10
7	Grey	±10
8	Yellow	±10
9	Orange	±10
10	Violet	±10
11	Light Green	±10
12	Light Blue	±10
13	Light Yellow	±10
14	Light Purple	±10
15	Light Orange	±10
16	Light Brown	±10
17	Light Grey	±10
18	Light White	±10
19	Light Black	±10
20	Light Red	±10
21	Light Green	±10
22	Light Blue	±10
23	Light Brown	±10
24	Light Yellow	±10
25	Light Purple	±10
26	Light Orange	±10
27	Light Brown	±10
28	Light Grey	±10
29	Light White	±10
30	Light Black	±10
31	Light Red	±10
32	Light Green	±10
33	Light Blue	±10
34	Light Brown	±10
35	Light Yellow	±10
36	Light Purple	±10
37	Light Orange	±10
38	Light Brown	±10
39	Light Grey	±10
40	Light White	±10
41	Light Black	±10
42	Light Red	±10
43	Light Green	±10
44	Light Blue	±10
45	Light Brown	±10
46	Light Yellow	±10
47	Light Purple	±10
48	Light Orange	±10
49	Light Brown	±10
50	Light Grey	±10
51	Light White	±10
52	Light Black	±10
53	Light Red	±10
54	Light Green	±10
55	Light Blue	±10
56	Light Brown	±10
57	Light Yellow	±10
58	Light Purple	±10
59	Light Orange	±10
60	Light Brown	±10
61	Light Grey	±10
62	Light White	±10
63	Light Black	±10
64	Light Red	±10
65	Light Green	±10
66	Light Blue	±10
67	Light Brown	±10
68	Light Yellow	±10
69	Light Purple	±10
70	Light Orange	±10
71	Light Brown	±10
72	Light Grey	±10
73	Light White	±10
74	Light Black	±10
75	Light Red	±10
76	Light Green	±10
77	Light Blue	±10
78	Light Brown	±10
79	Light Yellow	±10
80	Light Purple	±10
81	Light Orange	±10
82	Light Brown	±10
83	Light Grey	±10
84	Light White	±10
85	Light Black	±10
86	Light Red	±10
87	Light Green	±10
88	Light Blue	±10
89	Light Brown	±10
90	Light Yellow	±10
91	Light Purple	±10
92	Light Orange	±10
93	Light Brown	±10
94	Light Grey	±10
95	Light White	±10
96	Light Black	±10
97	Light Red	±10
98	Light Green	±10
99	Light Blue	±10
100	Light Brown	±10

UNIS

Design: []
 Drawing: []
 Bolite: []
 Check: []
 Approve: []

Name: **Circle Train Wiring Diagram (CEC Ver.)**
 Chart: []
 Date: 27.10.2015
 Page: []

Version: []
 Drawing NO: []
 Chart: (CEC)GDxHC-PX-00(2/2)

Author: []
 Designer: []
 Drafter: []
 Checker: []
 Approver: []